

Model KYA SQUARE TYPE BLOCK

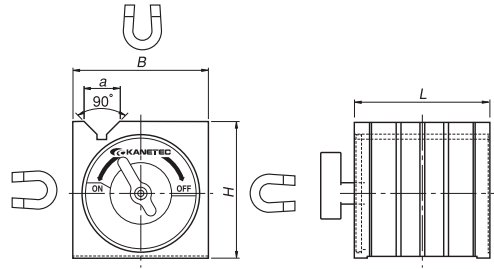

KYA-8A



[Application]

Holding tools for marking and light duty machining.
Holding tools for electric discharge machining.

Holding tools for three-dimensional measuring instruments and various measuring systems.

[Features]

- Workpieces can be held on three faces of top (V face) and both side faces.
- T-handle ON/OFF switch comes attached, but can be removed.
- They are of dripproof and oilproof construction.
- An M8 tapped hole is provided on the top for lifting (KYA-18 only).
- Super high accuracy finish is also available. Please contact us.

Model	Holding Power	Dimensions				Mass
		B	H	L	a	
KYA- 8A	200N (20kgf) or over	80 (3.14)	80 (3.14)	80 (3.14)	20 (0.78)	3.5kg/ 7.7 lb
KYA-13A	350N (35kgf) or over	125 (4.92)	125 (4.92)	125 (4.92)	30 (1.18)	14kg/30.8 lb
KYA-18A	550N (55kgf) or over	180 (7.08)	180 (7.08)	180 (7.08)	38 (1.49)	41kg/90.3 lb

※ The holding power applies to the V-face and φ 20 round bar. ※For accuracy, see the table on page 51.

Model KYB SQUARE TYPE BLOCK



(Picture is old model for reference)

KYB-8

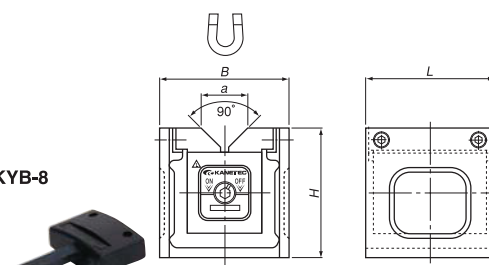

[Application]

Holding tools for marking and light duty machining.
Holding tools for electric discharge machining.

Holding tools for three-dimensional measuring instruments and various measuring systems.

[Features]

- Workpieces can be held on one face of top (V face).
- T-handle ON/OFF switch comes attached, but can be removed.
- They are of dripproof and oilproof construction.
- Super high accuracy finish is also available. Please contact us.

Model	Holding Power	Dimensions				Mass
		B	H	L	a	
KYB- 8A	180N (18kgf) or over	80 (3.14)	80 (3.14)	80 (3.14)	30 (1.18)	2.5kg/ 5.5 lb
KYB-13A	400N (40kgf) or over	125 (4.92)	125 (4.92)	125 (4.92)	40 (1.57)	8kg/17.6 lb
KYB-18A	600N (60kgf) or over	180 (7.08)	180 (7.08)	180 (7.08)	50 (1.96)	16.5kg/36.3 lb

※ The holding power applies to the V-face and φ 20 round bar. ※For accuracy, see the table on page 51.

Model KVA MAGNETIC V-HOLDER

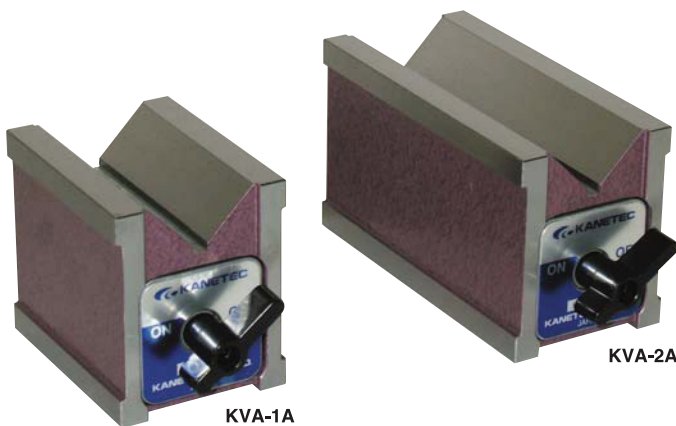

KVA-1A

KVA-2A

[Application]

Holding tools for round bar marking, drilling, tapping and grinding of irregular-shaped workpieces.

Holding tools for electric discharge machining.

Holding tools for three-dimensional measuring instruments and various measuring systems.

[Features]

- Workpieces can be held on the top face (V face), bottom face, and rear face.
- T-handle ON/OFF switch comes attached, but can be removed.
- They are of dripproof and oilproof construction.
- Super high accuracy finish is also available. Please contact us.

Model	Holding Power	Dimensions				Mass
		B	H	L	a	
KVA-1A	300N (30kgf) or over	60 (2.36)	73 (2.87)	80 (3.14)	38 (1.49)	2kg/4.4 lb
KVA-2A	450N (45kgf) or over			125 (4.92)		3kg/6.6 lb
KVA-3A	700N (70kgf) or over			180 (7.08)		4.5kg/10 lb

※ The holding power applies to the V-face and φ 20 round bar. ※For accuracy, see the table on page 51.

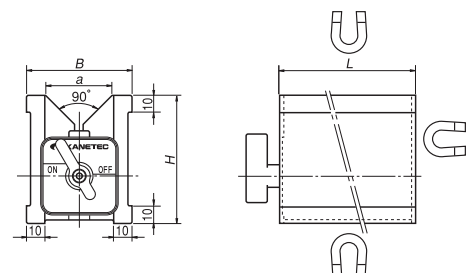

■The dimensional accuracy of KYA, KYB and KVA is based on Kanetec's in-house standard. When you need higher accuracy, please contact us.

ELECTROMAGNETIC CHUCKS
CHUCK CONTROLLERS
PERMANENT MAGNETIC CHUCKS
PERMANENT ELECTROMAGNETIC CHUCKS
BLOCKS FOR MC
VACUUM CHUCKS
PROMELTA SYSTEM
SINE BAR CHUCKS
INJECTION MOLDING MACHINE MOLD FIXTURE
WORKING TOOLS
MAGNETIC BLOCKS
MEASURING TOOL HOLDERS